

CATENA

Catena a maglia normale calibrata o con traversino unificata in acciaio speciale.

Finitura con zincatura a fuoco. Fornitura con collaudo interno fabbrica.

A richiesta: collaudo di Registri Navali e/o diametri superiori.

CHAIN

Unified normal calibrated link chain or stud link chain. Made of high tensile steel. Hot galvanizing finish.

Supplied with performance test carried out by our technicians in our workshop.

On request: fitted with test certification issued by Naval Registers of Shipping and/or with larger diameters.

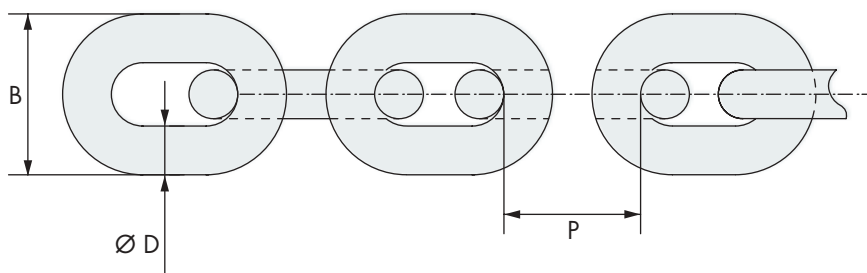

CATENA G2 A MAGLIA NORMALE / SHORT LINK G2 CHAIN

CODICE	Dimensione - Size			Carico di prova	Min. carico di rottura	Peso
Code	D Ø	P	B	Proof test	Min. breaking force	Weight
	mm	mm	mm	kN	kN	kg/m
3800300	8	24	26	2048	4100	1,4
3800400	10	30	35	3200	6300	2,35
3800500	12	36	40	4000	8500	3,3
3800600	14	42	47	5600	12000	4,4
3800700	16	48	54	8200	15000	6,1
3800800	18	54	59	10050	20000	7,8
3800900	20	60	66	12840	24000	9,3
3801000	22	66	75	14000	26000	11,4

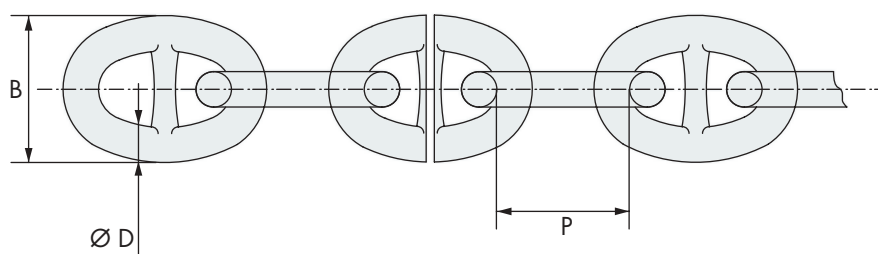

CATENA CON TRAVERSINO G2 / STUD LINK G2 CHAIN

CODICE	Dimensione - Size			Carico di prova	Min. carico di rottura	Peso per 27,5 m. con Kenter
Code	D Ø	P	B	Proof test	Min. breaking force	Weight for 27.5 m. with Kenter
	mm	mm	mm	kN	kN	kg
3811000	16	64	58	107	150	161
3812000	17,5	70	63	127	179	191
3813000	19	76	68	150	211	222
3814000	20,5	82	74	175	244	255
3815000	22	88	79	200	280	294
3816000	24	96	86	237	332	355
3817000	26	104	94	278	383	417
3818000	28	112	101	321	449	489